

**TESmart**

# User Manual

2x2 Dual Monitor  
Hybrid KVM Switch

HDMI  
DP  
USB-C



HDC202 Prime 23

To Enjoy Smart

HDC202 Prime 23

English





# **English**





## **Preface**

It's our great honor that you have chosen the hybrid KVM Switch produced by our company, Tesla Ele Technology Co.,Ltd. In this user manual, you will learn how to operate and use this product. Please read this user manual comprehensively before use. If you have any questions, comments or suggestions, please contact us via the following email:

support@tesmart.com.

## **Copyright Notice**

The user manual, compiled by Tesla Elec Technology Co.,Ltd, shall not be duplicated or translated by any person or organizations without written permission. This user manual shall not be used for commodity transaction in any form or by any means (electronically, mechanically, photocopying or recording, etc.) or be used for any business practices or profitable activities. The ownership of the trade names and brand names adopted in this user manual belongs to their companies.

## **Product Information**

For more information about TESmart products and how they can help you to enjoy your job, please visit the following TESmart website or contact the TESmart Authorized Reseller.

---

**www.tesmart.com**









---

# Contents

1. Safety Tips and Warnings .....	01	9.4 Built-in Network Switch	
2. Battery Description.....	02	9.5 Built-in Charging Module	
3. Warranty Information.....	03	9.6 Mouse Wheel Switching	
4. Preface.....	04	10. Operation Method.....	28
5. Features.....	05	10.1 Front Panel Button Switching Method	
6. Packing List.....	06	10.2 IR Remote Control	
7. Panel Description.....	07	10.3 Keyboard Hot Keys	
8. Connection Description.....	10	11. Change Hot Key Combination.....	34
8.1 Connection Diagram			
8.2 Connection Preparation			
8.3 Connection Steps			
8.4 KVM Workbench			
9. Function Description.....	18		
9.1 MST Mode Description			
9.2 Display Mode Description			
9.3 Keyboard and Mouse Emulation Mode			

## 1. Safety Tips and Warnings

**Tips:** Please read the safety tips and warnings for KVM Switch comprehensively before use. Use this produce in accordance with its instructions, safety tips and warnings to prevent unnecessary damage to the product and potential dangers to users.

-  Keep the product away from water.
-  Clean the product with dry cloth.
-  Use the product in accordance with its instructions and do not block its vents.
-  Keep the product away from ignition sources, such as heat sinks, heat accumulators, stovepipes and other heat production settings (including audio amplifiers).
-  Do not touch the product and the power cord with wet hands so as to lower the risk of electric shock and damage to the product. Do not let the product get wet or become damp.
-  Unplug the power supply of this product in thunderstorm days or when it has been not used for a long time.
-  Do not expose this product and its battery to open fire or overheating environment. Dispose the waste battery in accordance with instructions.
-  Users shall not remove and repair the product without authorization.

## 2. Battery Description

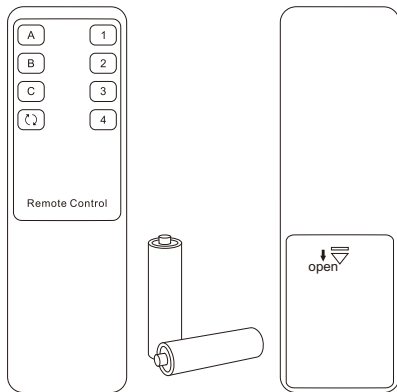

**Tips:** By default, the remote control is not equipped with batteries, due to the safety requirements of some express companies. Install AAA dry cells before use.

**Caution:** Improper disposal of the lithium battery may cause an explosion. Do not throw the battery into fire. Keep the battery away from children. Dispose the waste battery in accordance with local regulations.





### 3. Warranty Information

We warrant this product as free of defects in material and workmanship for a period of one (1) year from the date of shipment. If during the period of warranty this product proves defective under normal use, we will repair or replace this product, provided that this product has not been subjected to mechanical, electrical, or other abuse or modifications. If it fails under conditions other than those covered will be repaired at the current price of parts and labor in effect at the time of repair. Such repairs are warranted for six (6) months from the day of reshipment to the buyer.

## 4. Preface

Dear Users,

2x2 Hybrid KVM Switch that integrates USB-C device and other PC into a desktop workstation. It comes with USB Type-C functionality that transfers video, audio, data, and even supports directly and securely USB-C device charging. That means with a single USB-C cable, users can reduce bulky cable setups. At the same time, USB-C supports MST (Multi-Stream Transport), enabling a dual-screen setup with a single cable, eliminating the need for a docking station. This saves both desktop space and costs.

This KVM support USB 3.0 ports with superspeed data transfer rate. With USB charge port on the front panel, support BC 1.2 protocol to charge devices like mobile phones and tablets. The built-in Ethernet port supports gigabit network connections, allowing users to stay abreast of the latest multimedia trends on their desktop and work more efficiently. At the same time, with EDID emulators in each input port, it can keep PCs always having correct display information.

**Tips:** If you need to control more computers or conduct more complex and professional switching, you can also choose other products of our company. For more details, please visit our official website: [www.tesmart.com](http://www.tesmart.com).

## 5. Features

- Using 2 monitors, 1 set of keyboard and mouse to control 2 computers
- Support resolution up to 3840x2160@60Hz 4:4:4
- HDMI 2.0 compliant
- Support MST(Multi-Stream Transport) mode
- Support 2 display modes
- Support Unix/Windows/ Debian/ Ubuntu/Fedora/ MacOS X/ Raspbian/ Ubuntu for Raspberry Pi and other Linux based systems
- Support Gigabit wired network connection, 2 PCs connected to KVM can access to the network with only one network cable
- With EDID emulators in each input port, it can keep PCs always having correct display information
- Support USB 3.0 port with super-speed data transfer rate
- Support various ways to control the KVM to switch input ports
- Support passthrough mode and legacy emulation mode, significantly improving compatibility for keyboards and mice
- Support charging the devices connected to the port marked 'A' & 'WIN'
- Support connecting mobile device to the front panel USB ports to charge

## 6. Packing List

- 1 \* 2x2 Hybrid KVM Switch
- 1 \* KVM Cable
- 1 \* DisplayPort Cable
- 2 \* USB-C Cables
- 1 \* IR Remote Control
- 1 \* DC 20V Power Adapter
- 1 \* User Manual

**Tips:** After receipt of the product, please check the packing list carefully to make sure that no components have been lost and no damage to the product has been caused during transportation. If you have any problem, please contact us at any time.

## 7. Panel Description

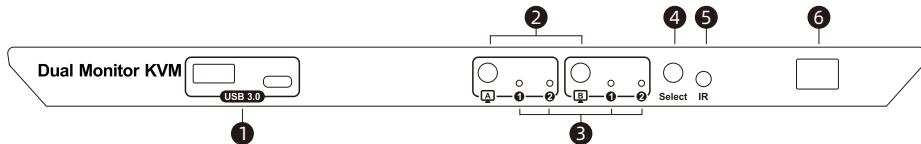

ID	Name	Function	ID	Name	Function
1	Data transfer and charging ports	Can be used to transfer data and charge your mobile devices.	2	Separate switch button	Switch images on each display separately (i.e. display mode 2).
3	Input selection status indicators	The corresponding LEDs will be lit to indicate the current selected computer on each display.	4	Input selection button	Select input sources (i.e. display mode 1).
5	IR receiver	Receive IR remote signal.	6	Power switch	Turn on or turn off power supply.

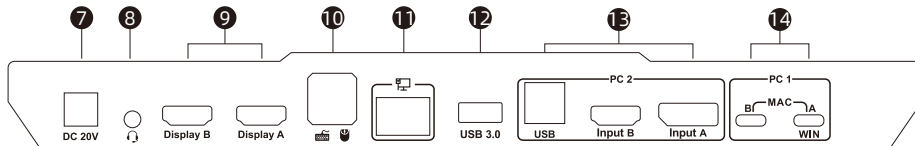

ID	Name	Function
7	DC 20V	20V DC power supply.
8	Audio integration port	Integrated microphone and L/R audio output.
9	HDMI outputs	Connect to 2 HDMI displays for video output.
10	Keyboard and mouse input	For USB keyboard and mouse input.
11	LAN port	Insert the network cable into this port to let the 2 input PCs to connect to the local network area
12	USB 3.0 ports	Connect to USB 3.0 devices.

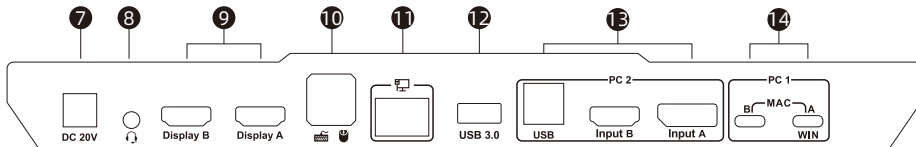

ID	Name	Function
13	PC2 connection ports (For general devices)	Contains 1 DP port and 1 HDMI port(marked as Input A&B) and a USB port. Connect the ports to corresponding input devices for signal input. Devices connected to these ports <b>cannot</b> be charged.
14	PC1 connection ports (For Type-C charging devices)	Contains 2 type-C ports. Connect the ports to the devices with type-C ports for signal input. Connect the device to the port marked 'A' to charge it. Please refer to Page 12~13 for how to connect laptops with different operating systems.

## 8. Connection Description

### 8.1 Connection Diagram

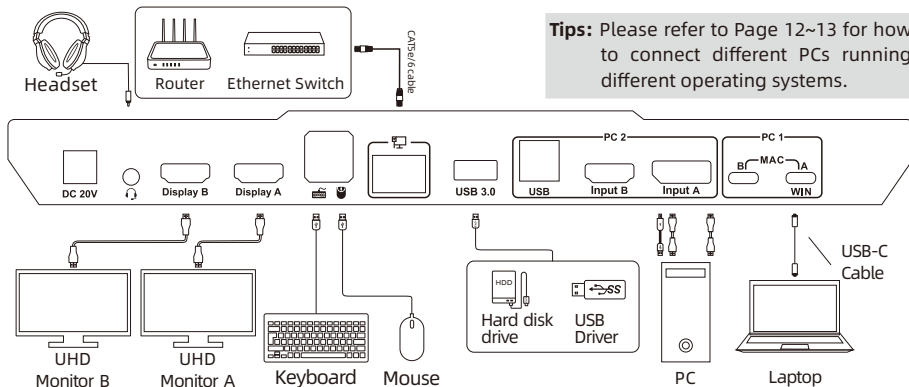

**Tips:** Please refer to Page 12~13 for how to connect different PCs running different operating systems.

**Tips:** 1. For your convenience, we suggest you connect each group port on the KVM to the same PC.  
2. Please refer to Page 26 for how to use the front panel charging port.



## 8.2 Connection Preparation

- Take into consideration all devices required to be connected and prepare a workbench large enough before the connection.
- Lay out the cables properly to facilitate the layout of power supply as a lot of power sockets and plug boards will be adopted in connection.
- Prepare different sticker labels to mark cables as a lot of cables will be adopted in connection.

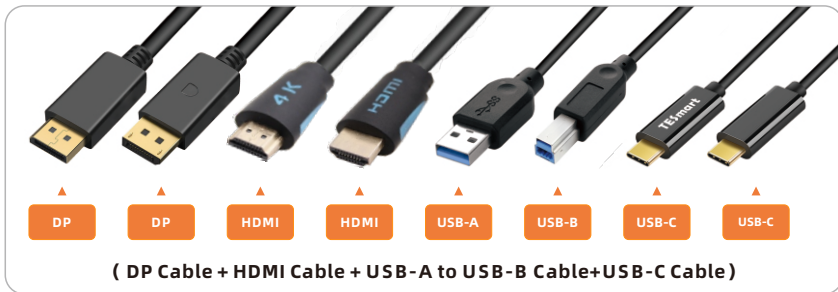

## 8.3 Connection Steps

1. Connect PC 1 in different cases as follows.

- **A. If your Type-C laptop is running Windows OS:**

Connect the laptop to the Input port marked 'A' of the KVM with 1 USB-C cable to enable the MST mode. Connect 2 USB-C cables to the Input 'A' & 'B' or only Input ports marked 'B' to disable the MST mode (As shown below).



**Tips:** 1. To ensure proper video transmission, please confirm that your laptop supports DP Alt Mode or Thunderbolt 3 and above protocols.

2. Please refer to Page 18 for the detailed information about the MST mode.

- **B. If your Type-C laptops are running MacOS:**

Connect your laptop to the Input 'A' & 'B' ports of the KVM with 2 USB-C cables.



2. Connect PC 2 with 1 DP cable and 1 KVM cable.



3. Connect external mouse and keyboard to KVM's keyboard and mouse input port.



4. Connect USB 3.0 devices to KVM's standard USB 3.0 ports.



5. Connect KVM's HDMI output ports to 2 HDMI displays with 2 HDMI cables.



6. Use the network cable to connect the LAN port on the KVM Switch to a router or local area network switch.



7. Connect external audio device to KVM's audio port.

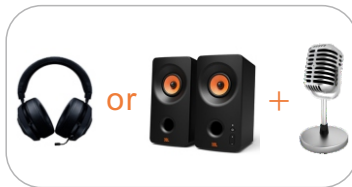

8. Connect the power cable to KVM's DC 20V port and plug it to a power socket.



**Tips:** 1. By default, the network cable is not included in the package.  
2. Please refer to Page 24 for the detailed information about the LAN port.

By now, the connection has been completed. Turn on the power supply and the KVM Switch will begin to work.

## 8.4 KVM Workbench

A workbench with 2x2 Hybrid KVM Switch successfully connected is shown as below:



## 9. Function Description

### 9.1 MST Mode Description

The traditional dual monitor KVM switch needs to connect two cables to each input device for the normal use of the dual monitor function. But our 2x2 Hybrid KVM Switch support Multi-Stream Transport(MST) mode allowing dual HDMI displays from a single USB-C source.

- **Multi-Stream Transport mode:**

If your Windows OS PC with USB-C port and is DisplayPort 1.2 compliant, you can adopt two console displays from it. Support extend mode and duplicate mode at resolutions up to 4K for multitasking across two displays.

- **Operation method**

Connect USB-C input devices and 2 UHD monitors according to the pictures in next page, the display mode will enable MST mode automatically.

**Tips:** Up to now, devices running Apple's MacOS, Ubuntu and other operating systems do not support MST mode.



- **Enable MST mode**

Connect the laptop to the input port marked 'A' on the KVM with a single USB-C cable.

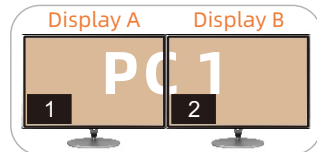
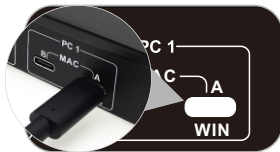

**Tips:** 1. Only the port marked 'A' supports the MST mode.

2. As shown below, if your PC is not Windows OS and has 2 USB-C ports supporting video output, connecting them to the input port group will also enable dual monitor displays.

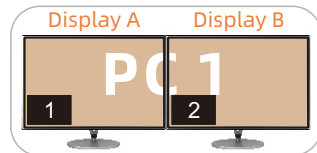
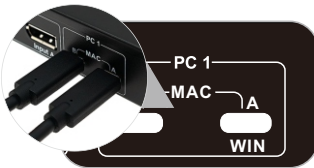

## 9.2 Display Mode Description

The 2x2 Hybrid KVM Switch support 2 display mode. You can choose to implement 2-screen extended display or duplicate display or display different PCs on 2 monitors.

### Display Mode 1: Display the same PC



**Tips:** You can set the duplicate or extend displays in the Display Settings of the current selected PC.

## Display Mode 2: Display the different PCs

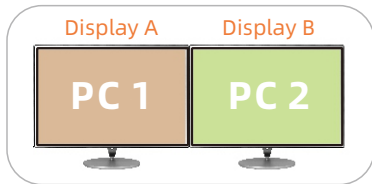

Once the connection is complete, you can switch between images on any of your 2 monitors. When you view one of the monitors as the main monitor, you can use hot key command to switch the images on the subordinate monitor. We will use a schematic diagram below to illustrate this function.

**Tips:** When different PCs are displayed on different monitors, you can double-click the **Right-[Alt]** on the keyboard connected to the KVM to switch the focus between different PCs.

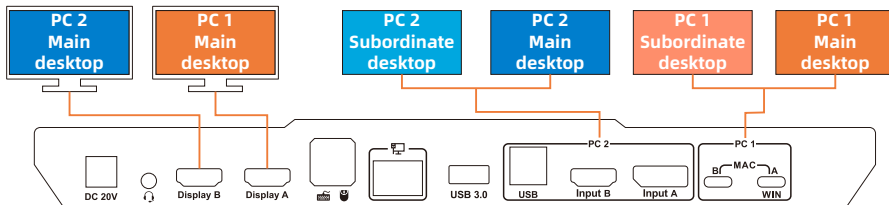

If you think of Display A as the main display, use the following hot key command to switch images on the Display B:

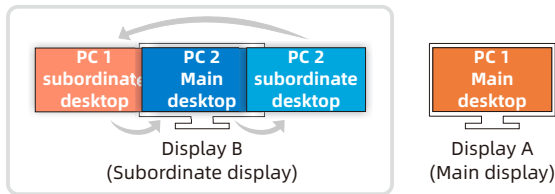

If you think of Display B as the main display, use the following hot key command to switch images on the Display A:

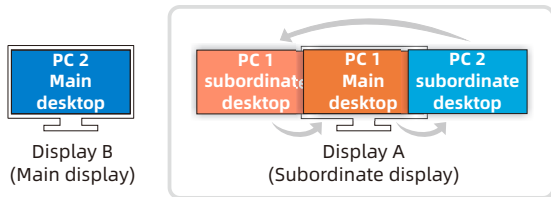

**Tips:** 1. The image currently displayed on the main monitor will not be displayed on the subordinate monitor after switching.

2. The PCs will keep the connections that are not displayed when switching in this mode.

## 9.3 Keyboard and Mouse Emulation Mode

We provide two keyboard and mouse modes: Pass Through Mode and Legacy Emulation Mode. Pass Through mode supports most keyboard and mouse drivers and multifunction keyboards and mice. Legacy Emulation Mode ensures the normal function of the keyboard, mouse, and hotkey features.

- Typically, we recommend using Passthrough Mode for an optimal user experience, allowing you to:



If you encounter issues with the keyboard and mouse in Passthrough Mode, we recommend switching to Legacy Emulation Mode.

**Tips:** 1. To toggle between two modes, please refer to Page 32. After toggled, please restart the KVM.  
2. In Legacy Emulation Mode, the keyboard and mouse control software will no longer be available.

## 9.4 Built-in Network Switch

The 2x2 hybrid KVM Switch have a built-in USB Ethernet Adapter, which adds a standard RJ45 port to all the PCs that are connected to the KVM and allows you to connect your computers to a router or network switch for gigabit wired network connection. Full 1000Mbps Ethernet for fast, stable data transfer, more reliable than most wireless connections. This feature has been added with a switch, allowing you to freely choose to enable or disable it.

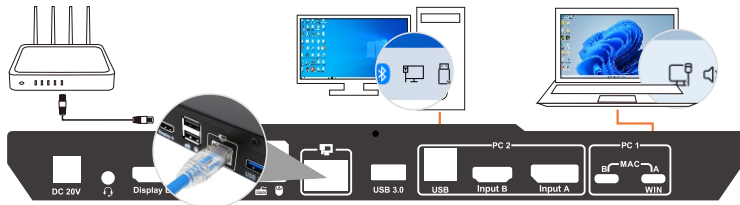

- Tips:**
1. It is recommended to connect the USB cable to a USB 3.0 or higher port on the PC to achieve a Gigabit bandwidth network connection.
  2. The built-in network switch can be disabled separately. Please refer to Page 33 for the operating instructions.

## 9.5 Built-in Charging Module

The 2x2 Hybrid KVM Switch comes with a powerful built-in charging module that allows you to charge your laptops, phone, tablet and other devices while you use it.

- Connect the laptops to the rear Type-C video port of the KVM and they will be charged via the PD protocol.



**Tips:** Computer that connected to the PC2 port cannot be charged.

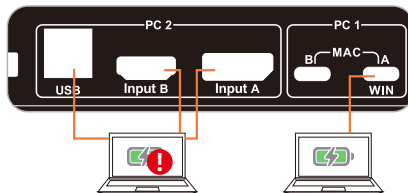

**Tips:** 1. The USB-C port on the laptop needs to support the charging protocol to be able to charge.  
2. Only by connecting the device to the port marked 'A' can it be charged.

**Tips:** When the laptop is connected both the KVM and the original charger, the charger will give priority to charge it.

- Connect the tablet, phone, ect to the front USB ports and it will be charged.



Use the USB ports on the front panel of the KVM (including an USB-A and an USB-C port) can support data transmission while charging. The USB ports support BC 1.2 protocol, and are able to match voltage and current automatically based on the specifications of charging devices. It makes your charging safe and avoids damage.



## 9.6 Mouse Wheel Switching

Mouse wheel switching method can quickly switch input sources by mouse operation, double-click the mouse wheel to switch to the next input port. Mouse wheel switching mode is off by default. You can use keyboard hotkey command to turn on mouse wheel switching mode. Please refer to Page 33.

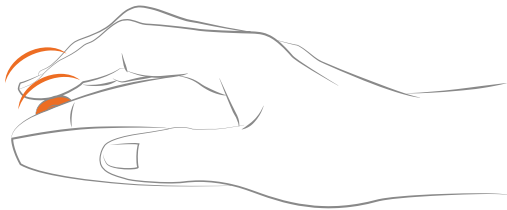

## 10. Operation Method

### 10.1 Front Panel Button Switching Method

The 2x2 Hybrid KVM Switch can switch to any input devices at any time with front panel keypad, IR remote control and keyboard hot keys. You can choose your favorite switching method according to your personal needs and habits.

- Press **[Select]** button to switch between PCs on display mode 1.



- Press **[A]/[B]** button to switch between PCs on corresponding monitor on display mode 2. The indicator lights blue means the current PC's main desktop is displayed on the marked monitor, it lights green means the current PC's subordinate desktop is displayed on the marked monitor.

## 10.2 IR Remote Control

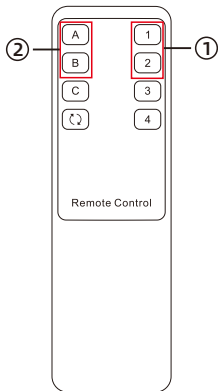

- ① — Press directly to select among 2 PCs, and 2 displays will display the selected PC at the same time. (i.e. display mode 1)
- ② — Press the key to make the selected monitor display the selected PC. (i.e. display mode 2)

**Tips:** Unspecified buttons at above are non-functional.

## 10.3 Keyboard Hot Keys

→ Use external keyboard hot keys to switch the input source or set up some other functions..

**Tips:** The keyboard hot keys can only work with external keyboard correctly connected to the keyboard and mouse input port of the KVM.

After press **[Right-Ctrl]** key twice within 2 seconds then please enter the commands within 3 seconds and the KVM will execute the corresponding commands.

Select previous input port:

**[Right-Ctrl]→[Right-Ctrl]→[PgUp]**



Select next input port:

**[Right-Ctrl]→[Right-Ctrl]→[PgDn]**



Select port by port number(i.e. display mode 1):

**[Right-Ctrl]→[Right-Ctrl]→[1]~[2]**



### Switch to display mode 2:

Think of display A as main display, switch images on display B:

**[Right-Ctrl]→[Right-Ctrl]→[→]**



Think of display B as main display, switch images on display A:

**[Right-Ctrl]→[Right-Ctrl]→[←]**



Switch USB 3.0 device connected to the KVM between 2 PCs on display mode 2:

**[Right-Ctrl]→[Right-Ctrl]→[↑]**



Switch audio focus between 2 PCs:

**[Right-Ctrl]→[Right-Ctrl]→[↓]**



Switch KM focus in display mode 2:

**[Right-Alt]→[Right-Alt]**



Turn on auto scan mode:

[Right-Ctrl] → [Right-Ctrl] → [Space]



**Tips:** The default auto scan time interval is 5 seconds. You can change the time interval by the front panel buttons or following the step presented below.

Increase or decrease auto scan time interval:

[Right-Ctrl] → [Right-Ctrl] → [ + ] / [ - ]



**Tips:** This hot key command can only work while the auto scan mode is activated. Press [Right-Ctrl] twice and keep pressing [ + ] / [ - ] key to adjust the time interval continuously. Increase or decrease 1 second at one time.

Press [Esc] to exit auto scan mode.



Toggle between keyboard and mouse modes:

[Right-Ctrl] → [Right-Ctrl] → [F2]

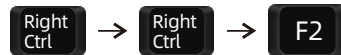

**Tips:** The default keyboard and mouse mode is Pass Through mode. When switching to Compatibility Mode, the buzzer will emit 2 short beeps; when switching to Pass Through Mode, the buzzer will emit only 1 short beep.

Disable/enable the current displayed PC's built-in network card:

[Right-Ctrl] → [Right-Ctrl] → [F4]



**Tips:** The built-in network card is enabled by default. Enable it will trigger the buzzer to beep twice and disable it will trigger the buzzer to beep once.

Turn on/off mouse wheel switching mode:

[Right-Ctrl] → [Right-Ctrl] → [F6]



**Tips:** Turning on the mouse wheel switching mode will trigger the buzzer to beep twice and turning it off will trigger the buzzer to beep once.

Disable or enable buzzer sound:

[Right-Ctrl] → [Right-Ctrl] → [F11]



**Tips:** The default setting of buzzer sound is enabled. Disable buzzer sound will trigger the buzzer to beep once and enable it will trigger the buzzer to beep twice.

## 11. Change Hot Key Combinations

For your convenience, we have built-in a custom hotkey function. By setting, you can use any key on the keyboard connected to the KVM as the trigger key for the hot key command. The default hotkey trigger key is the **[Right-CTRL]**. The custom hotkey function can be set in the following ways:

### Method 1:

- After powering on the KVM, press and keep holding the **[Select]** button on the front panel for 10 seconds until you hear the buzzer has a 5 seconds tone. Please press the key you want to use as the hot key trigger key on the keyboard within 5 seconds. After pressing the button, the prompt tone ends and the setting is complete.

### Method 2:

- Press **[Right-Ctrl]→[Right-Ctrl]→[F1]**, then the buzzer will have a 5 seconds tone. Please press the key you want to use as the hot key trigger key on the keyboard within 5 seconds. After pressing the button, the prompt tone ends and the setting is complete.







**TESmart**

# To Enjoy Smart

---

HDC202 Prime 23

Tesla Elec Technology Co.,Ltd

CE FC   HDCP 

WEEE-Reg.-Nr. DE 66784279